

Madison, Wisconsin

CITY OF MADISON

CITY ENGINEERING DIVISION

DEPARTMENT OF PUBLIC WORKS

PLAN OF PROPOSED IMPROVEMENT

SOUTH LIVINGSTON STREET RECONSTRUCTION ASSESSMENT DISTRICT - 2020

INDEX OF SHEETS

SHEET NO. D1	TYPICAL STREET SECTION
SHEET NO. P1	PLAN & PROFILES
SHEET NO. E1	ELECTRICAL
SHEET NO. X1-X2	CROSS SECTIONS

CITY PROJECT NO. 12695
CONTRACT NO. 8516

CONVENTIONAL SIGNS	
FIELD VERIFY ALL UTILITY LOCATIONS	
GAS	— G —
STORM SEWER	— ST —
SANITARY SEWER	— SAN —
WATER	— W —
BURIED ELECTRIC	— E —
OVERHEAD ELECTRIC	— OH —
POWER POLE	□
ADA COMPLIANT RAMP W/ DETECTABLE WARNING FIELD	▤
COMBUSTIBLE FLUIDS	☀

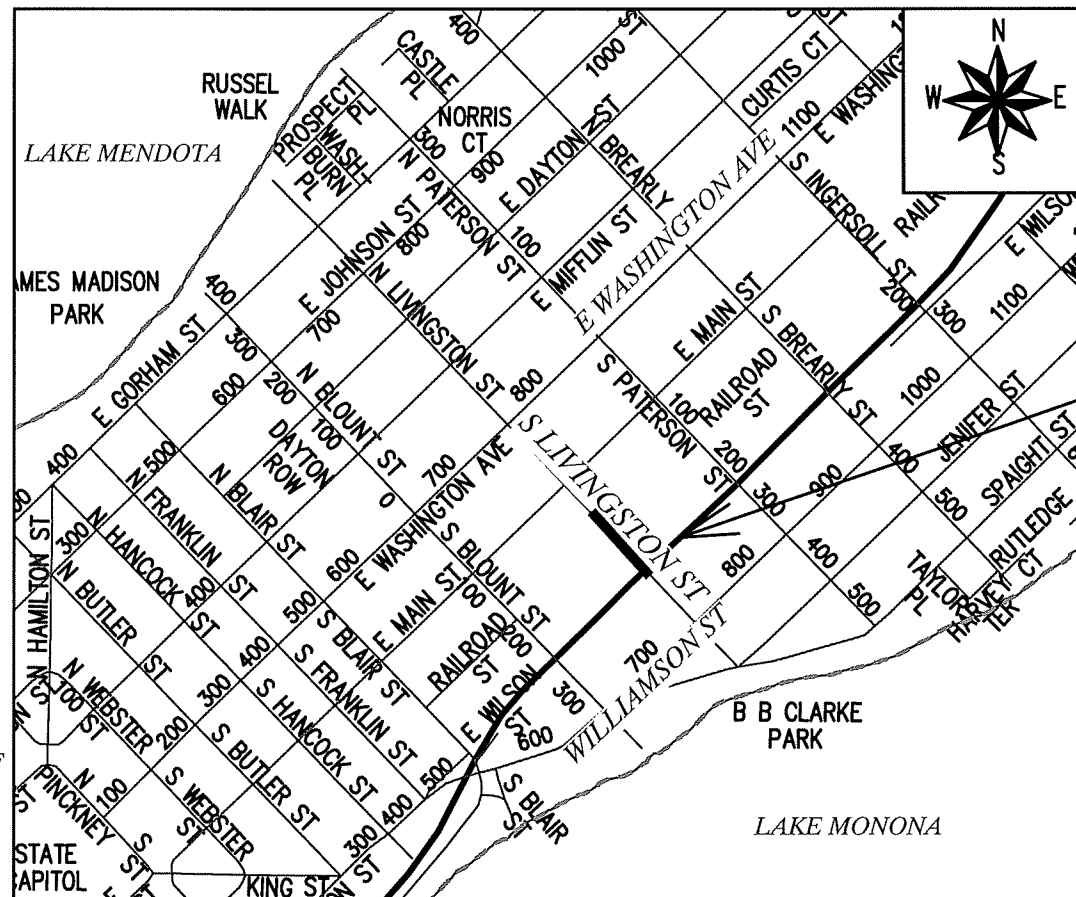

PROJECT
LOCATION

PUBLIC IMPROVEMENT PROJECT
APPROVED

APPROVED DATE: JANUARY 21, 2020

BY THE COMMON COUNCIL
OF MADISON, WISCONSIN

PUBLIC IMPROVEMENT DESIGN
APPROVED BY:

 2/6/20
City Engineer Date

STREET
DESIGNED BY:



PLOT SCALE: 1" = 1'

REV. DATE: 2/4/2020 1:18 PM

ORIGINATOR: CITY OF MADISON

NOTES:

ALL GUTTERS SHALL DRAIN WITH A MINIMUM GRADE OF 0.50% TOWARD STORM SEWER INLETS.

EARTH WORK SUMMARY:

EXCAVATION CUT (MEASURED PLAN QUANTITY) = 609.47 C.Y.
ESTIMATED UNDISTRIBUTED UNDERCUT = 66.00 C.Y.
TOTAL UNCLASSIFIED EXCAVATION CUT = 675.47 C.Y.

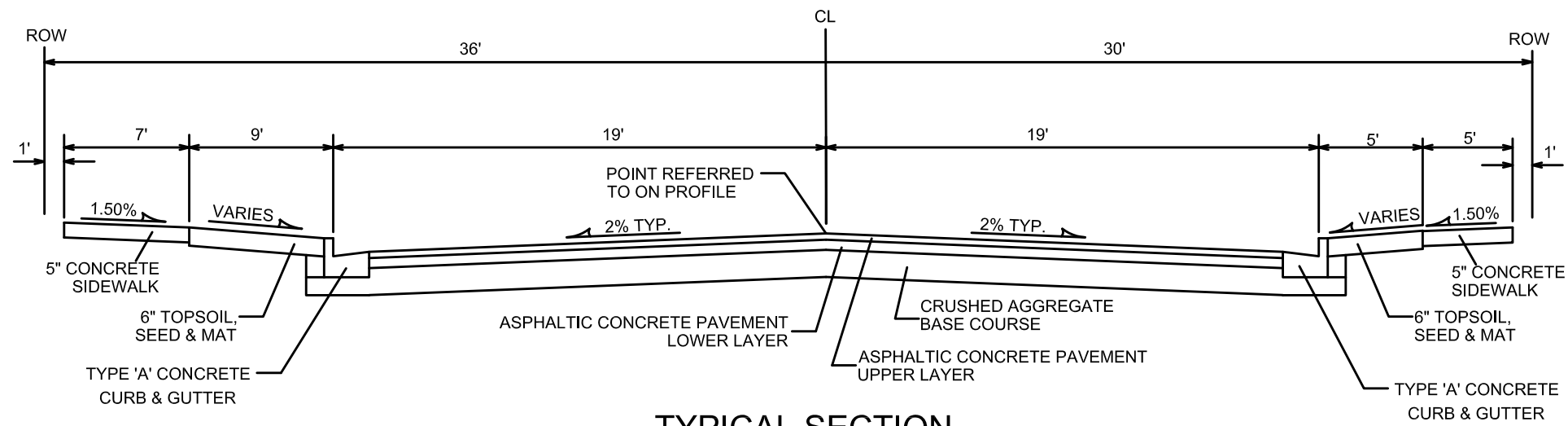

TYPICAL SECTION
SOUTH LIVINGSTON STREET
NOT TO SCALE

CITY OF MADISON MINIMUM PAVEMENT DESIGN

TYPE	CRUSHED AGGREGATE BASE COURSE		ASPHALTIC CONCRETE PAVEMENT			
	LOWER LAYER GRADATION 1	UPPER LAYER GRADATION 2	LOWER LAYER		UPPER LAYER	
			TYPE	THICKNESS	TYPE	THICKNESS
A	6"	6"	4 LT 58-28 S	1.75"	4 LT 58-28 S	1.75"
B	6"	6"	3 LT 58-28 S	2.50"	4 LT 58-28 S	2.00"
C	6"	6"	3 MT 58-28 S/H	3.50"	4 MT 58-28 S/H	2.00"

NOTES:
SOUTH LIVINGSTON SHALL BE TYPE B PAVEMENT

MARK	REVISION	DATE	BY
12695			
Designed By: SMS	Dated: 1-29-2020	Scale: NOT TO SCALE	

12695
S. LIVINGSTON ST. REC. ASSESSMENT DISTRICT - 2020
MADISON, MADISON, WI
CITY OF MADISON
CONTRACT NO: 8516



12695
D-1

0709-134-1203-0
CITY OF MADISON PARKING
CAPITAL EAST RAMP
111 S Livingston St

0709-134-1202-2
MADISON GAS & ELECTRIC
ATTN TIM BLIEFERNICHT
211 S Livingston St

0709-134-1201-4
STATE OF WI WISDOT
%WSOR
224 S Paterson St

0709-134-1313-7
RENAISSANCE PROPERTIES
LLC
301 S Livingston St

0709-133-0401-3
MADISON GAS & ELECTRIC
ATTN TIM BLIEFERNICHT
717 E Main St

0709-134-1802-0
MADISON GAS & ELECTRIC
ATTN TIM BLIEFERNICHT
201 S Blount St

0709-134-1801-2
STATE OF WI WISDOT
%WSOR
223 S Blount St

0709-134-1712-1
300 SOUTH LIVINGSTON LLC
302 S Livingston St

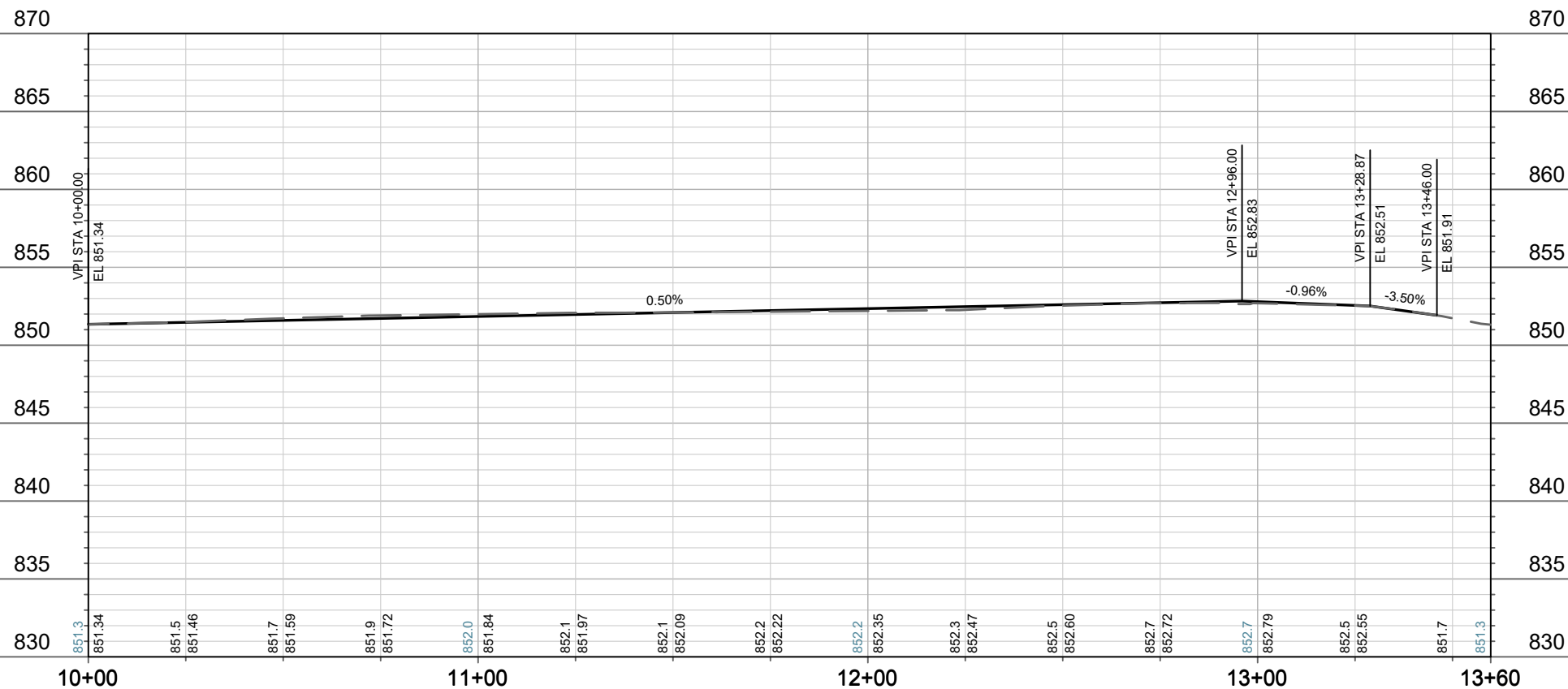
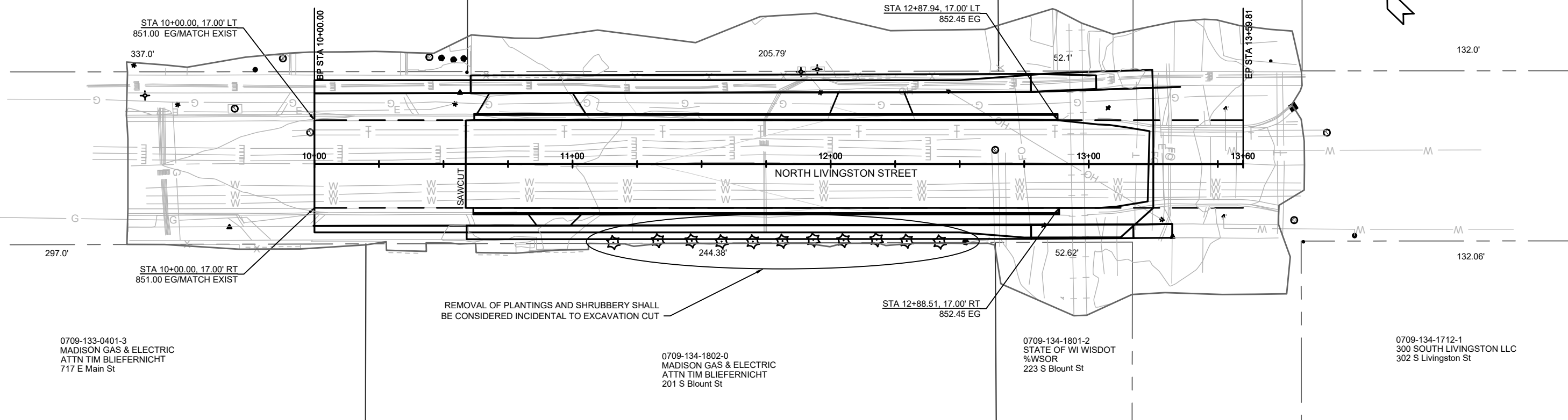

MARK	REVISION	DATE	BY

12695
MADISON, WI
CONTRACT NO: 8516

SOUTH LIVINGSTON STREET PLAN & PROFILE
SOUTH LIVINGSTON ST RECONSTRUCTION - 2020
M:\DESIGN\Projects\12695\CAD\Plan_Sheets\LIVINGSTON PnP.dwg



12695
P-1

0709-134-1203-0
CITY OF MADISON PARKING
CAPITAL EAST RAMP
111 S Livingston St

0709-134-1202-2
MADISON GAS & ELECTRIC
ATTN TIM BLIEFERNICHT
211 S Livingston St

0709-134-1201-4
STATE OF WI WISDOT
%WSOR
224 S Paterson St

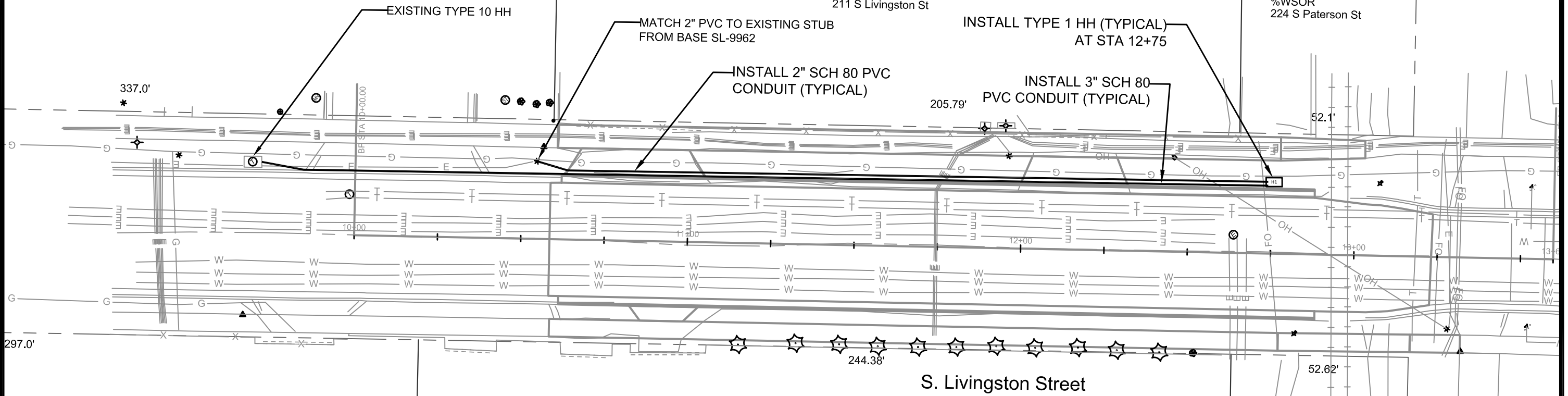

1. THE CONTRACTOR SHALL DO ALL WORK IN ACCORDANCE WITH CITY OF MADISON STANDARD SPECIFICATIONS FOR PUBLIC WORKS CONSTRUCTION 2020 EDITION AND ALL ADDENDUMS HERETO. ALL CONDUIT SHALL BE PVC SCHEDULE 80 UNDER PAVEMENT OR SCHEDULE 40 OTHERWISE. PULL WIRE REQUIRED AS PER STANDARD SPECIFICATIONS
2. THE CONTRACTOR SHALL CALL MIKE BENZSCHAWEL (266-4767) AT THE TRAFFIC ENGINEERING SHOP AT LEAST 24-HOURS IN ADVANCE OF BURYING CONDUIT TO ARRANGE FOR INSPECTION.
3. ALL LOCATIONS ARE APPROXIMATE, THE TRAFFIC ENGINEER SHALL APPROVE FINAL LOCATIONS, INCLUDING SETBACK, IN THE FIELD, THE CONTRACTOR SHALL NOTIFY MIKE BENZSCHAWEL (266-4767) CITY TRAFFIC ENGINEERING, AT LEAST 24-HOURS IN ADVANCE OF NEEDING BASE LOCATIONS MARKED.

0709-134-1802-0
MADISON GAS & ELECTRIC
ATTN TIM BLIEFERNICHT
201 S Blount St

0709-134-1801-2
STATE OF WI WISDOT
%WSOR
223 S Blount St

0709-133-0401-3
MADISON GAS & ELECTRIC
ATTN TIM BLIEFERNICHT
717 E Main St

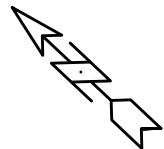

MARK	REVISION	DATE	BY
12695			
Designated By: SDM	Drawn: 02-06-2020	Scale: 1:30	E-1

12695
MADISON, WI
8516
CONTRACT NO:
SOUTH LIVINGSTON ST RECONSTRUCTION - 2020
M:\DESIGN\Projects\12695\CAD\Traffic\12695TE-Electrical.dwg



12695
E-1

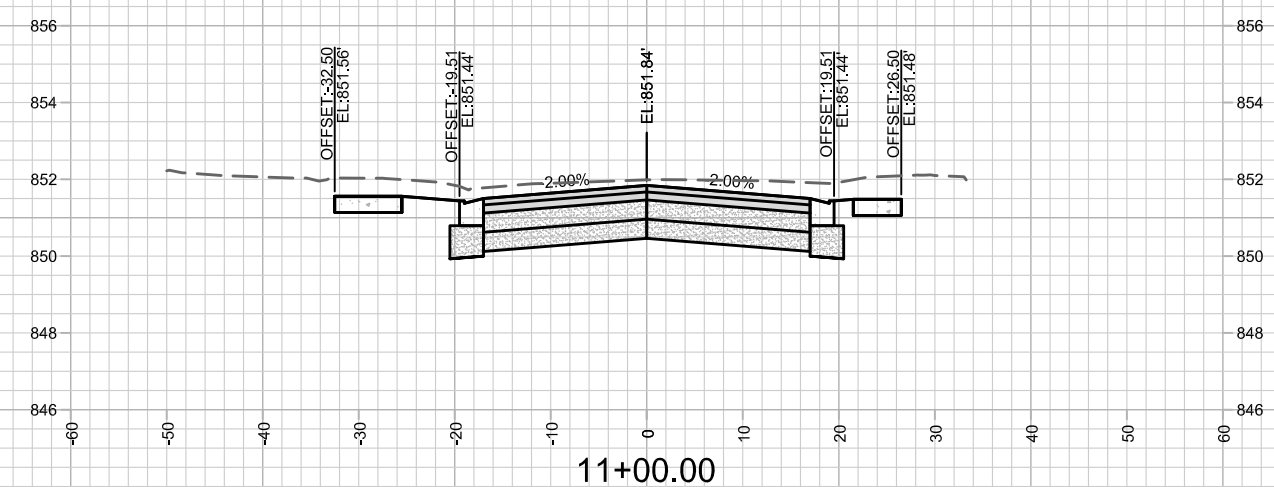
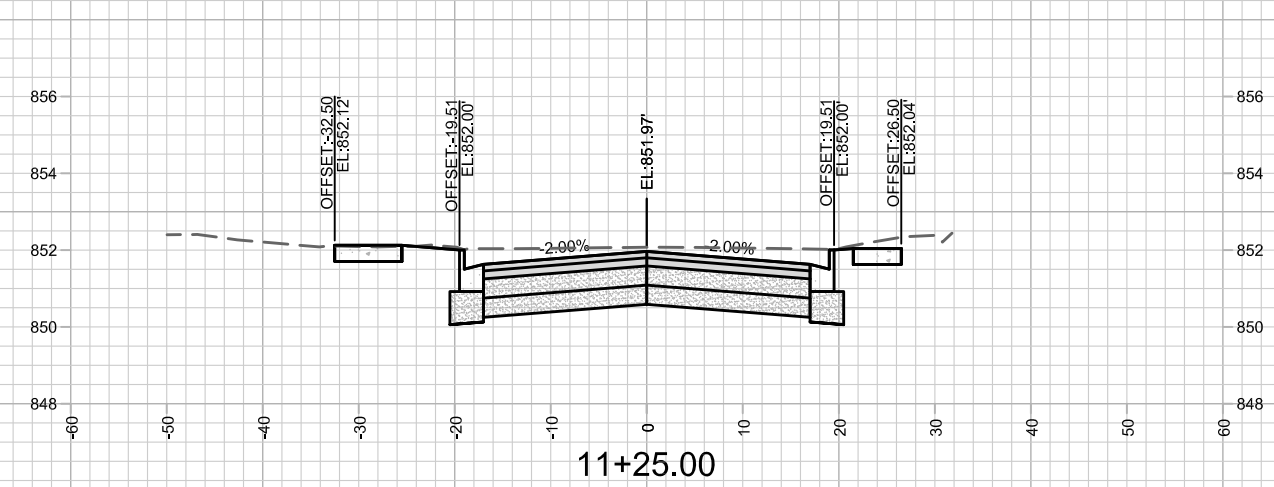
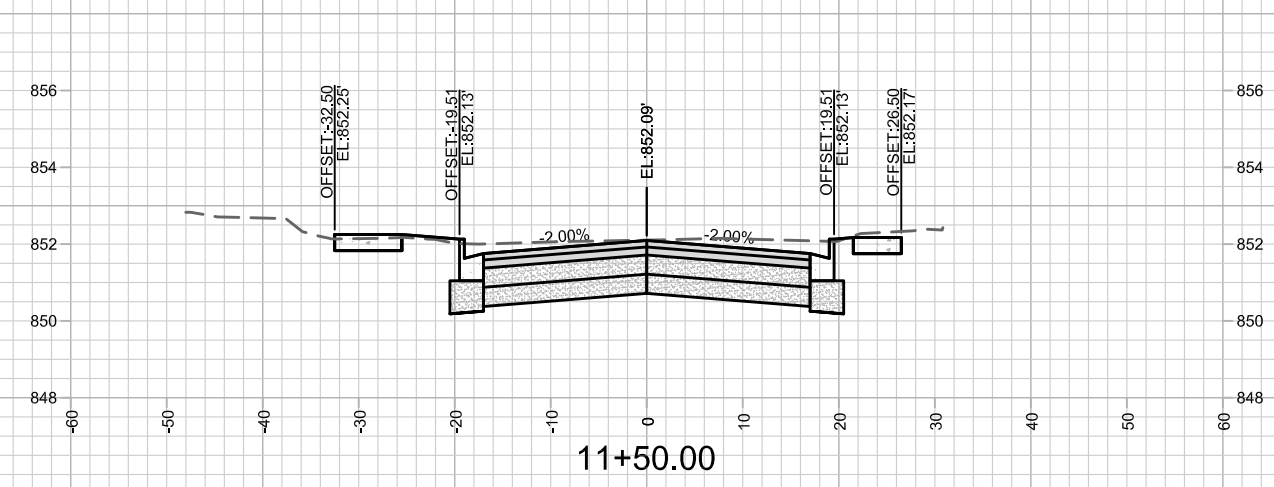
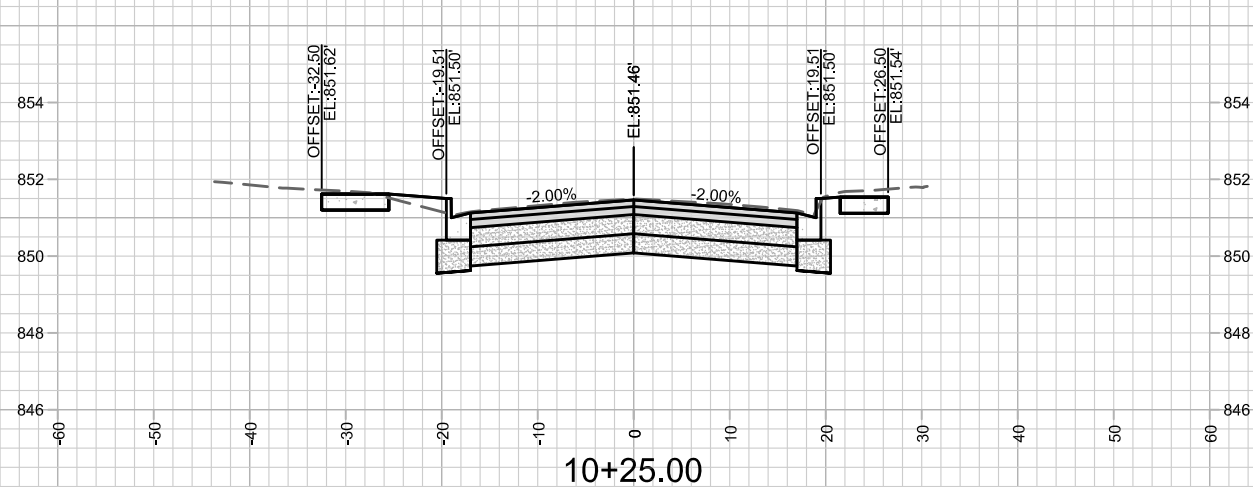
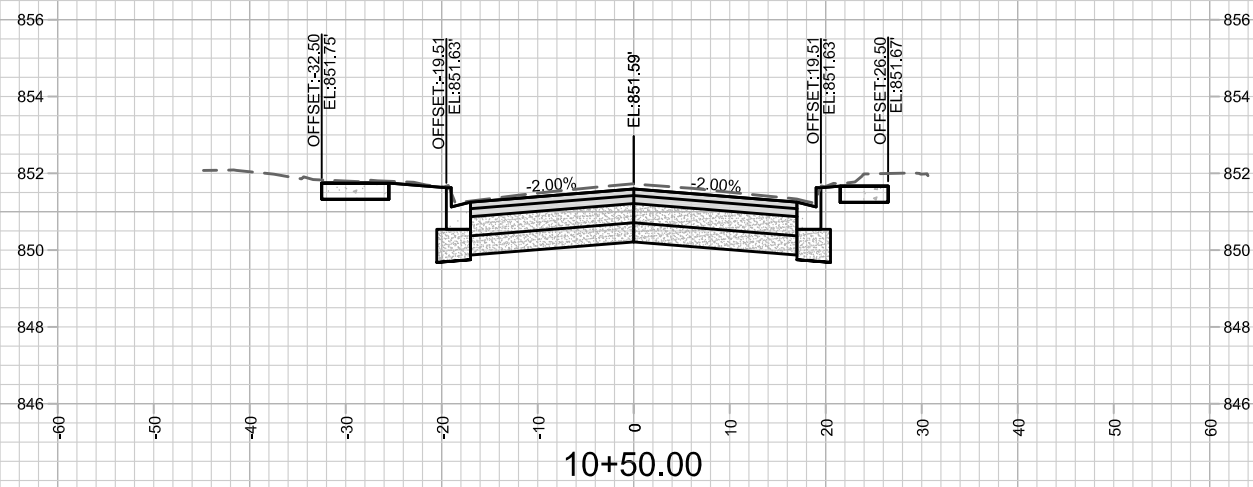
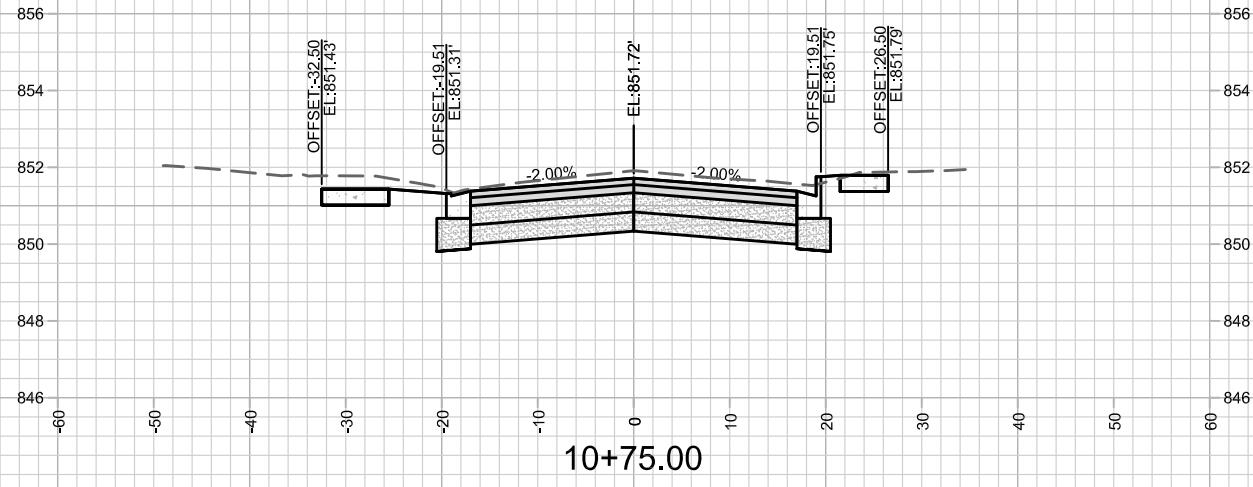

MARK	REVISION	DATE	BY

12695
MADISON, WI
8516
CONTRACT NO:

SOUTH LIVINGSTON STREET CROSS SECTION
SOUTH LIVINGSTON ST RECONSTRUCTION - 2020
M:\DESIGN\Projects\12695\CAD\Streets\12695EN-Streets_Corridor.dwg



12695
X-1

Designed By: SMS
Date: 2/9/2020 8:00 AM
Scale: 1" = 20'
X-1

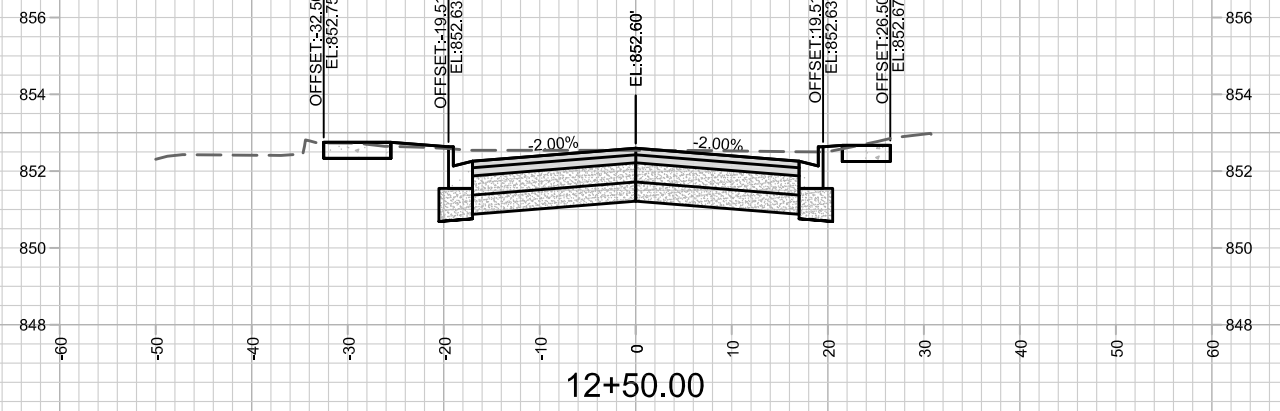
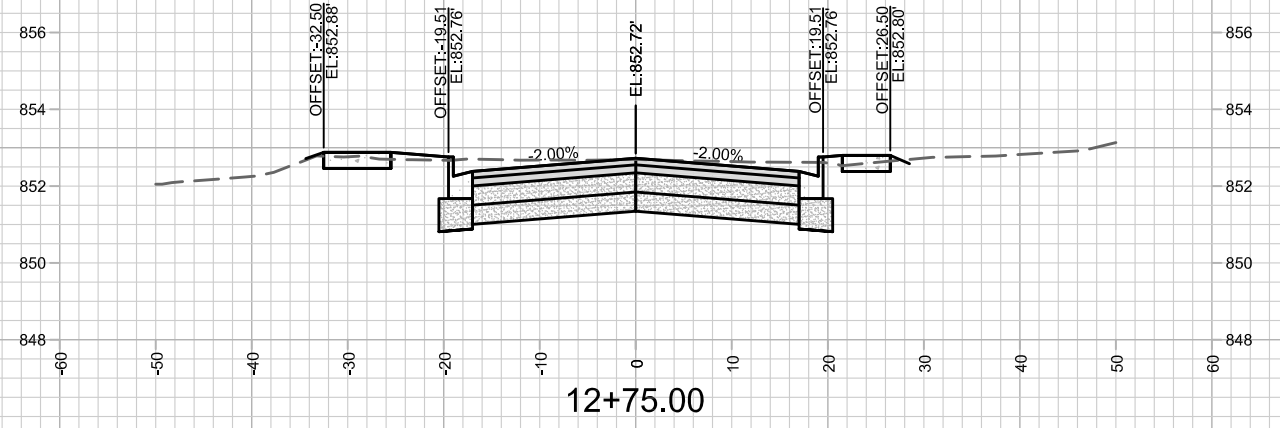
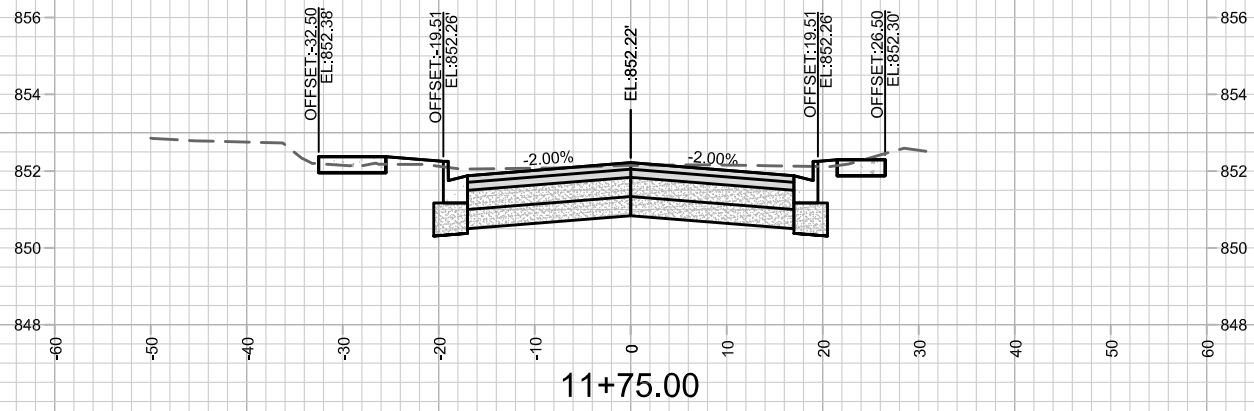
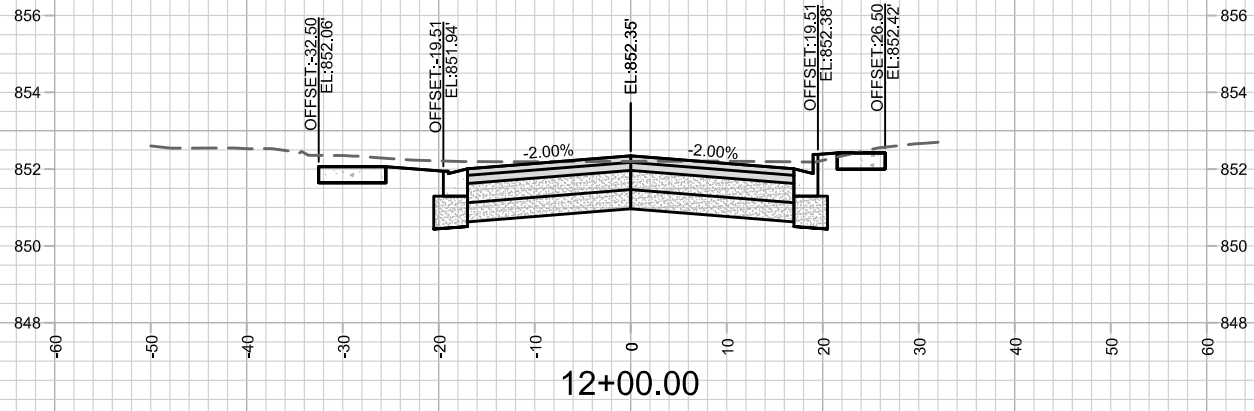
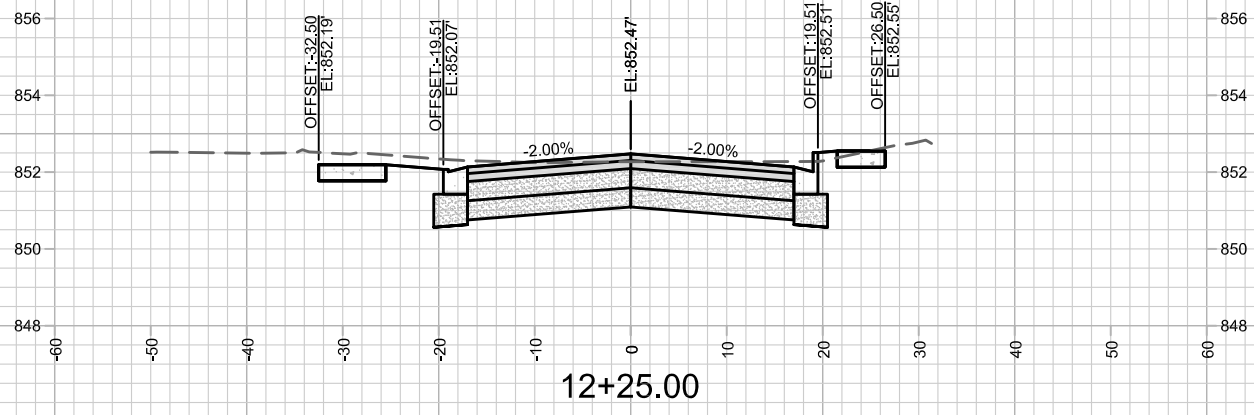

MARK	REVISION	DATE	BY
---	---	---	---
---	---	---	---
---	---	---	---

12695
MADISON, WI
8516
CONTRACT NO:

SOUTH LIVINGSTON STREET CROSS SECTION
SOUTH LIVINGSTON ST RECONSTRUCTION - 2020
M:\DESIGN\Projects\12695\CAD\Streets\12695EN-Streets_Corridor.dwg



12695
X-2